

**Service Bulletin No:** 21-006  
**Modification No:** EC-19-0747

**Ref No:** 87  
**ATA Chapter:** 21

---

**ENVIRONMENTAL CONTROL - LIQUID/GAS COOLANT  
REPLACEMENT OF THE COCKPIT AND CABIN EVAPORATOR FILTERS**

**1. Planning information**

**A. Effectivity**

PC-24 aircraft MSN 101 thru MSN 162, MSN 164, MSN 167 and MSN 168.

This modification has been incorporated on MSN 163, MSN 165 and MSN 166 in production.

This modification will be incorporated on MSN 169 and subsequent during production.

**B. Concurrent requirements**

None.

**C. Reason**

**(1) Problem**

The supplier of the cockpit and cabin evaporator filter assemblies has informed Pilatus of a quality escape with their evaporator filter material. Configuration control issues resulted in filters with degraded fire retardant properties being supplied in error.

**(2) Solution**

Replace the cockpit and cabin evaporator filters with the new filters that are made from a different material.

**D. Description**

This Service Bulletin gives the data and instructions necessary to replace the cockpit and cabin evaporator filters.

**E. Compliance**

Mandatory.

This Service Bulletin must be embodied on all affected aircraft by 02 October 2020.

**F. Approval**

The technical content of this Service Bulletin is approved under the authority of DOA No. EASA. 21J. 357.

Pilatus advises Operators/Owners to check with their designated Airworthiness Authority for any changes, local regulations or sanctions that may affect the embodiment of this Service Bulletin.

**G. Copyright and legal statement**

© Pilatus Aircraft Ltd. This document contains proprietary information that is protected by copyright. All rights are reserved. No part of this document may be copied, reproduced or translated to other languages without the prior written consent of Pilatus Aircraft Ltd.

In connection with the use of this document, Pilatus does not provide any express or implied warranties and expressly disclaims any warranty of merchantability or fitness for a particular purpose. This document contains trade secrets, confidential and/or proprietary information of Pilatus and technical data subject to export control laws and regulations, including the U.S. Export Administration Regulations (EAR). Disclosure or distribution of this document contrary to the EAR, and other laws and regulations, is strictly forbidden. The above restrictions may apply to data on all pages of this document.

**H. Manpower**

Description	Man-Hours
Preparation	1.00
Modification	0.50
Requirements after job completion	1.00
<b>TOTAL MAN-HOURS</b>	<b>2.50</b>

**NOTE:** Man-hours do not include the time necessary to cure sealants, paints and adhesives.

**I. Weight and balance**

Not changed.

**J. Electrical load change data**

Not changed.

**K. Software**

Not changed.

**L. References**

Aircraft Maintenance Manual (AMM):

PC24-A-A06-40-0000-00A-040A-A      PC24-A-E20-10-0003-00A-913A-A

PC24-A-E24-00-0000-00A-913A-A      PC24-A-E25-10-0001-00A-520A-A

PC24-A-E25-10-0001-00A-720A-A.

**M. Publications affected**

Not applicable.

**N. Interchangeability of parts**

One way interchangeable. Pre-Service Bulletin parts must not be installed on post-Service Bulletin 21-006 aircraft.

**2. Material information**
**A. Material - Price and availability**

Operators that require additional information and/or Service Bulletin material can contact their authorized Pilatus Service Center, or Pilatus Customer Support on [www.pilatus-aircraft.com](http://www.pilatus-aircraft.com) → contact us.

**NOTE:** Part numbers given in this Service Bulletin are correct at the time of approval. Pilatus Aircraft Ltd. reserves the right to change the part numbers as necessary. Part numbers of items delivered with a kit are correct when the kit is dispatched. This could lead to differences between those part numbers quoted in a Service Bulletin and a kit if parts are superseded. Operators are requested to check the Illustrated Parts Data (IPD) for delivered parts that differ from those listed in the Service Bulletin materials kit list.

Operators are requested to advise Pilatus Aircraft Ltd. of the Manufacturer's Serial Number (MSN), the flying hours and landings of aircraft that are allocated for this Service Bulletin.

**B. Warranty**

Credit will be issued for parts and labour for all affected aircraft on approval of a warranty claim, provided the work is accomplished by an authorized Service Center within 6 months of the issue date of this Service Bulletin.

**C. Material necessary for each aircraft**

Modification kit number	Price	Availability
500.50.24.061	Contact as above	Approximately 1 to 2 weeks

**(1) Material to order from Pilatus**

Modification kit number 500.50.24.061

New part No.	Description	Old part No.	Qty	Disp. code	Fig	Item
959.90.20.303 (PC24EC-6068-5)	Filter Assembly, Cockpit	-	1	N	1	1
		-	1	D	-	-
959.90.20.304 (PC24EC-6287-5)	Filter Assembly, Front (Cabin)	-	1	N	2	4
		-	1	D	-	-
959.90.20.305 (PC24EC-6288-5)	Filter Assembly, Bottom (Cabin)	-	1	N	2	7
		-	1	D	-	-
959.90.20.306 (PC24EC-6297-5)	Filter Assembly, Top (Cabin)	-	1	N	2	9
		-	1	D	-	-

Disposition Codes: D - Discard / N - New / R - Return to Pilatus / E - Exchange part

**D. Operator supplied materials**

Not applicable.

**E. Material necessary for each spare**

Not applicable.

**F. Re-identified parts**

Not applicable.

**G. Tools and equipment**

Not applicable.

**3. Accomplishment instructions**

**WARNING:** BE CAREFUL WHEN YOU DO WORK ON THE ELECTRICAL SYSTEM OR A SYSTEM THAT USES THE ELECTRICAL POWER. MAKE SURE THAT IT IS SAFE BEFORE YOU APPLY ELECTRICAL POWER TO THE AIRCRAFT OR ENERGIZE THE AIRCRAFT ELECTRICAL SYSTEMS. THE ELECTRICAL POWER CAN CAUSE DEATH OR INJURY TO PERSONNEL AND CAUSE DAMAGE TO EQUIPMENT.

**A. Preparation**

- (1) Obey the safe maintenance practices as necessary. Refer to AMM, PC24-A-E20-10-0003-00A-913A-A.
- (2) If necessary, de-energize the aircraft electrical system. Refer to AMM, PC24-A-E24-00-0000-00A-913A-A.
- (3) Remove the pilot crew seat. Refer to AMM, PC24-A-E25-10-0001-00A-520A-A.
- (4) Open/Remove the access panels/fairings in Table 1. Refer to AMM, PC24-A-A06-40-0000-00A-040A-A.

**Table 1: Access panels/fairings to be opened/removed**

<b>Panel number</b>	<b>Panel name</b>
221HZ	Center console panel lower LH
221JZ	Cover, center console, lower
221KZ	Cover, center console MID upper
236ALC	Cover PSU AFT LH
236ARC	Cover PSU AFT RH
236GW	Cover, evaporator

**B. Modification****(1) Cockpit evaporator - Replacement of the filter assembly. Refer to Figure 1**

- (a) Disengage the retention rivet (4) that safeties the filter assembly, cockpit (1) on the cockpit evaporator (2).
- (b) Pull the existing filter assembly, cockpit (1) out of the retention rails (3) and discard.
- (c) Push the new filter assembly, cockpit (1) (Pilatus P/N 959.90.20.303) (Supplier P/N PC24EC-6068-5) into the retention rails (3).
- (d) Safety the filter assembly, cockpit (1) in position with the retention rivet (4).

**(2) Cabin evaporator - Replacement of the filter assemblies. Refer to Figure 2**

- (a) Disengage the retention rivet (3) that safeties the filter assembly, front (4) on the cabin evaporator (1).
- (b) Pull the filter assembly, front (4) out of the retention rails (2) and discard.
- (c) Disengage the retention rivet (6) that safeties the filter assembly, bottom (7) on the cabin evaporator (1).
- (d) Pull the filter assembly, bottom (7) out of the retention rails (5) and discard.
- (e) Disengage the retention rivet (10) that safeties the filter assembly, top (9) on the cabin evaporator (1).
- (f) Pull the filter assembly, top (9) out of the retention rails (8) and discard.
- (g) Push the new filter assembly, top (9) (Pilatus P/N 959.90.20.306) (Supplier P/N PC24EC-6297-5) fully into the retention rails (8).
- (h) Safety the filter assembly, top (9) in position with the retention rivet (10).
- (i) Push the new filter assembly, bottom (7) (Pilatus P/N 959.90.20.305) (Supplier P/N PC24EC-6288-5) fully into the retention rails (5).
- (j) Safety the filter assembly, bottom (7) in position with the retention rivet (6).
- (k) Push the new filter assembly, front (4) (Pilatus P/N 959.90.20.304) (Supplier P/N PC24EC-6287-5) fully into the retention rails (2).
- (l) Safety the filter assembly, front (4) in position with the retention rivet (3).

**C. Requirements after job completion**

- (1) Make sure that the work area is clean and clear of tools and other items.
- (2) Close/Install the access panels/fairings in Table 2. Refer to AMM, PC24-A-A06-40-0000-00A-040A-A.

**Table 2: Access panels/fairings to be closed/installed**

Panel number	Panel name
221HZ	Center console panel lower LH
221JZ	Cover, center console, lower
221KZ	Cover, center console MID upper
236ALC	Cover PSU AFT LH
236ARC	Cover PSU AFT RH
236GW	Cover, evaporator

- (3) Install the pilot crew seat. Refer to AMM, PC24-A-E25-10-0001-00A-720A-A.

**D. Documentation**

- (1) Make an entry in the Aircraft Logbook to record the incorporation of this Service Bulletin.
- (2) Make sure that the Aircraft Logbook shows any new Pilatus Part Number(s) and/or Serial Number(s), as applicable.
- (3) Inform CAMP of the incorporation of this Service Bulletin and any new Pilatus Part Number(s) and/or Serial Number(s), as applicable. Send to: [fax@campsystems.com](mailto:fax@campsystems.com)



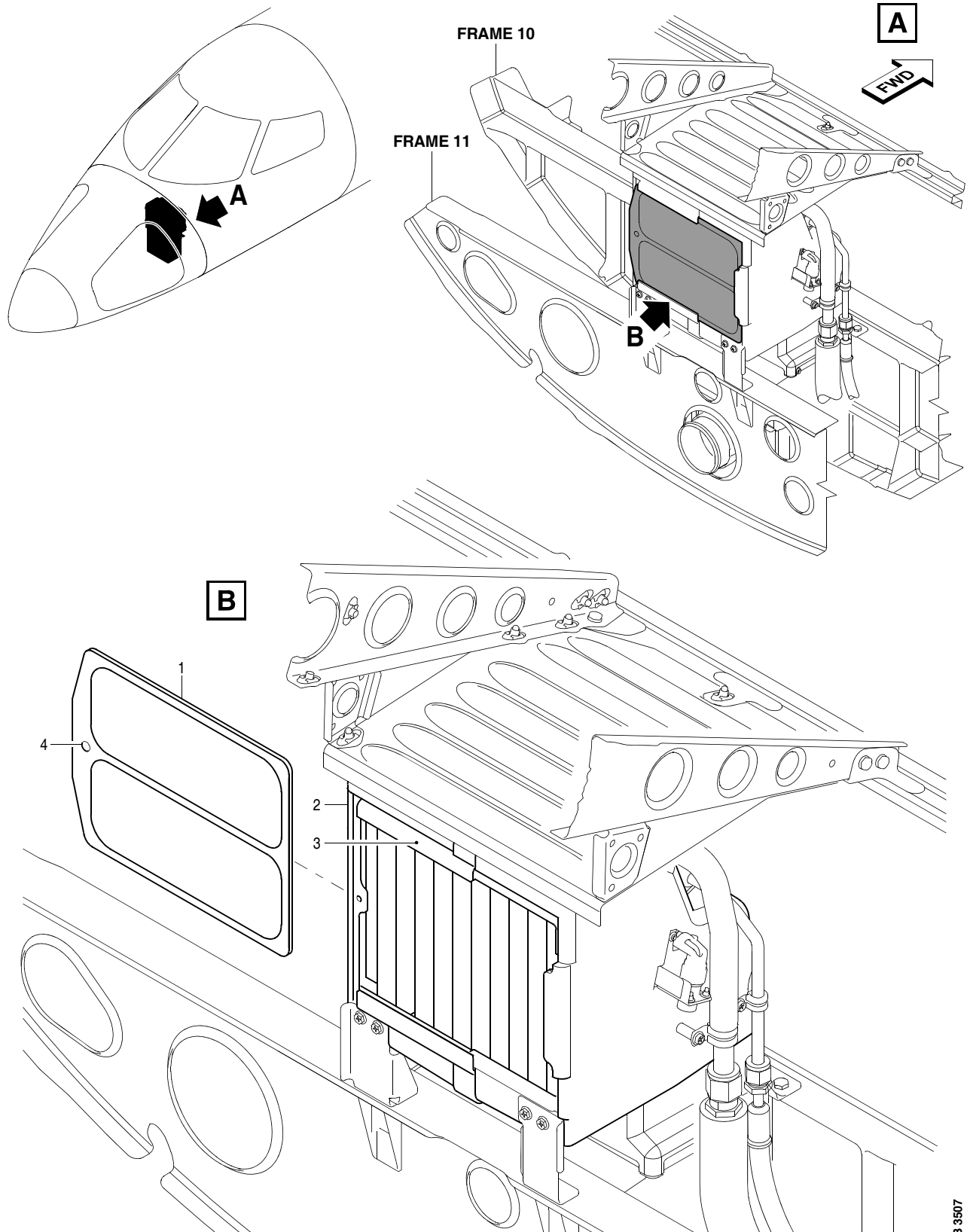

SB 3507

Replacement of the evaporator filter assembly - Cockpit  
Figure 1 (Pre and Post Service Bulletin)

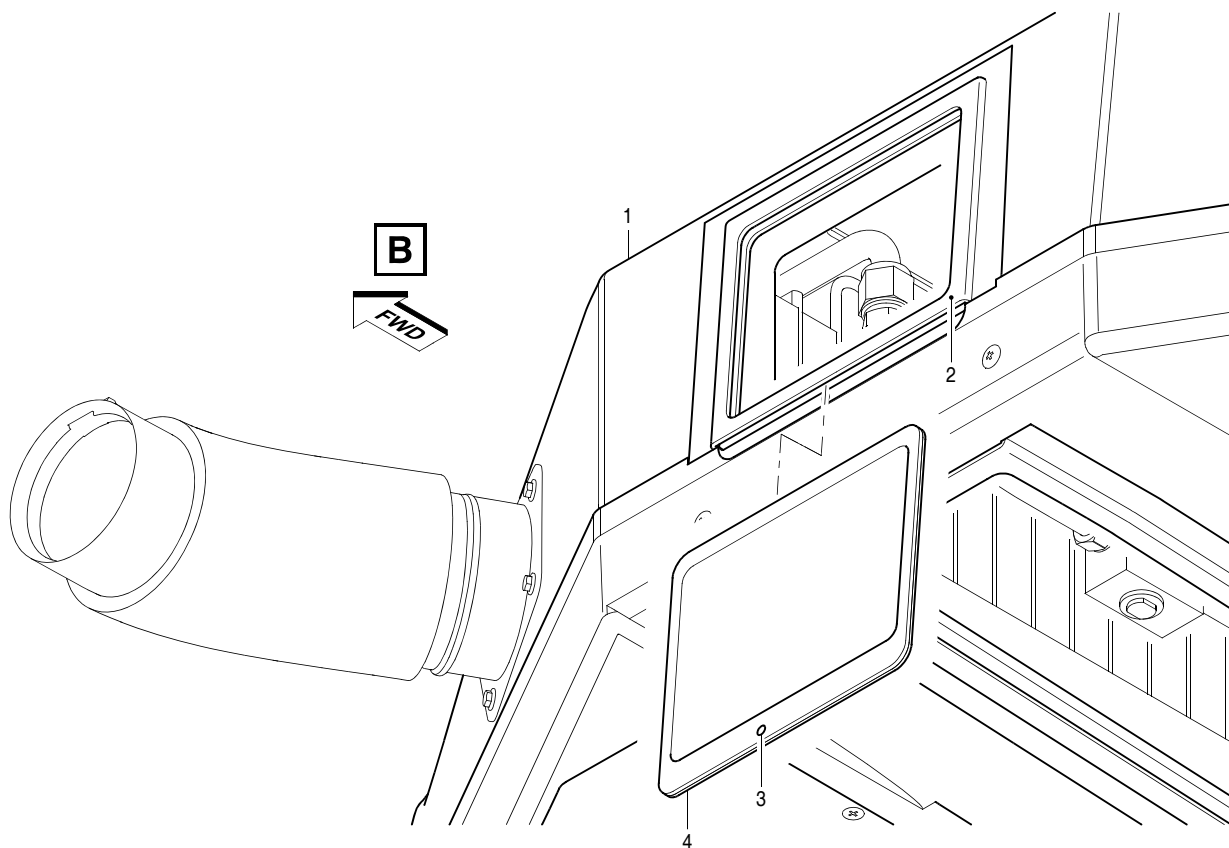
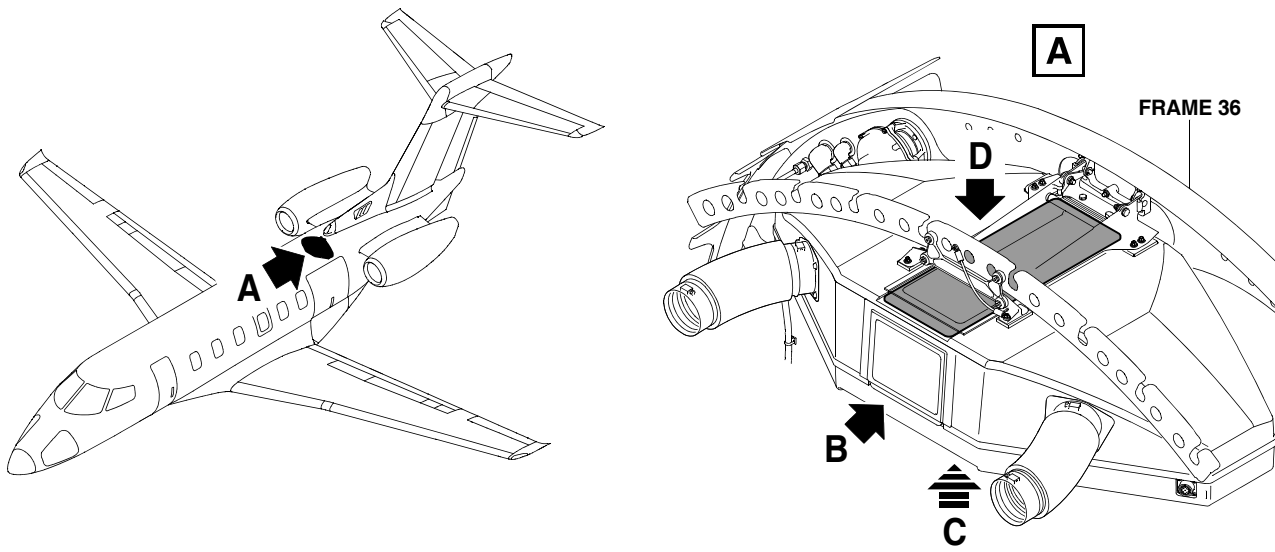

SB 3508

Replacement of the evaporator filter assemblies - Cabin  
Figure 2 (Sheet 1 of 2) (Pre and Post Service Bulletin)

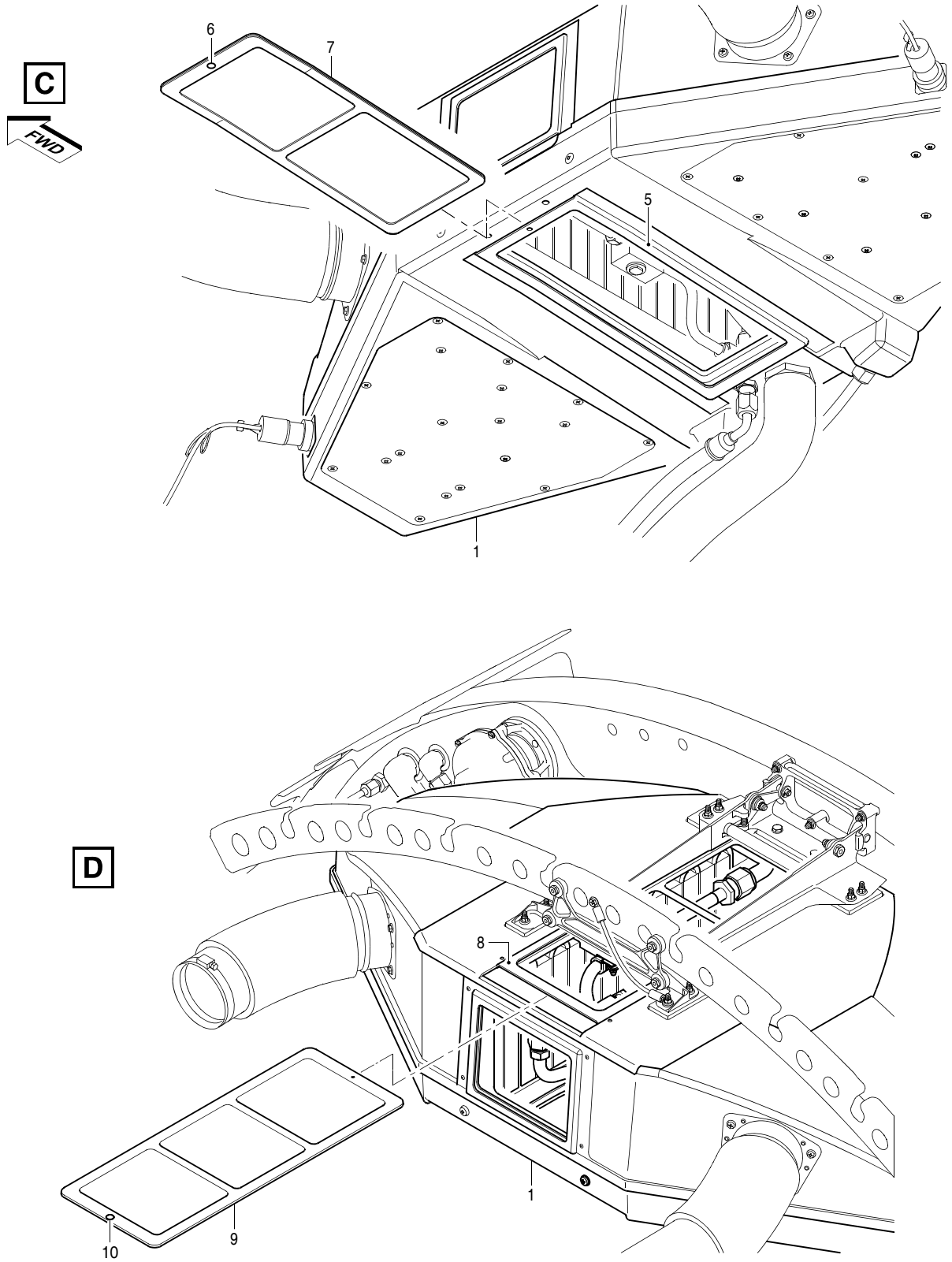

Replacement of the evaporator filter assemblies - Cabin  
Figure 2 (Sheet 2 of 2) (Pre and Post Service Bulletin)

INTENTIONALLY BLANK